

## SMD Power Inductor(HPIT Series) 贴片功率电感 HPIT 系列

### FEATURES 特点

- low profile, low RDC, high current handling capacities  
小尺寸、低直流电阻、高电流
- Magnetically shielded structure that ensures the high-density mounting configurations.  
高密度封装的磁屏蔽结构
- Flat bottom surface ensures secure, reliable mounting.  
平坦焊面便于安装
- Provided in embossed carrier tape packaging for use with automatic mounting machines. 编带包装便于自动贴装



### APPLICATIONS 应用

- Ideally used in Portable telephones, , PDA, DSC, DC-DC Converters, etc.  
用于手机、掌上电脑、数字信号控制器, DC-DC 转换等。

### Product Identification 产品标识

HPIT    3015   -   3R3    M    LF  
 ①            ②            ③            ④            ⑤

- ① Series Name 系列名称
- ② Product Dimensions 产品尺寸: (3015=3.0\*3.0\*1.5 mm )
- ③ Inductance Value 电感量: (R68=0.68uH 3R3=3.3uH 100=10uH)
- ④ Inductance Tolerance 电感量公差: ( M:20% ; N:30%)
- ⑤ Lead Free Products 无铅产品

### Shapes And Dimensions 外形及尺寸示意图

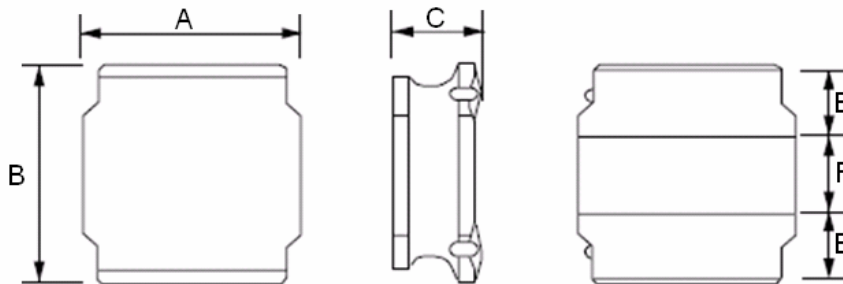

Series	Dimensions(mm)				
	A	B	C Max.	E Ref.	F Ref.
HPIT3010	3.0±0.3	3.0±0.3	1.2	0.90	1.0
HPIT3015	3.0±0.3	3.0±0.3	1.7	0.90	1.0
HPIT4018	4.0±0.3	4.0±0.3	2.0	1.10	1.4
HPIT4026	4.0±0.3	4.0±0.3	2.8	1.10	1.4
HPIT6045	6.0±0.3	6.0±0.3	4.5	1.35	2.7
HPIT8040	8.0±0.3	8.0±0.3	4.0	1.60	4.0

## SMD Power Inductor(HPIT Series) 贴片功率电感 HPIT 系列

### Recommended Footprint 焊位示意图

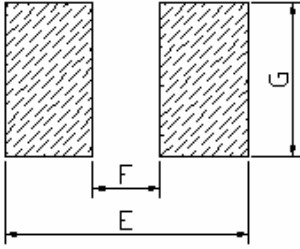

Series	Dimensions(mm)		
	E ref.	F ref.	G ref.
MPIT30 Series	3.0	1.6	2.7
MPIT40 Series	4.0	1.6	3.7
MPIT60 Series	6.3	3.1	5.7
MPIT80 Series	7.4	3.8	7.5

### Electrical Characteristics 电气性能

#### HPIT3010 Series

Part Number	L (uH)	Tolerance (±%)	Rdc Max.(mΩ)	Idc Typ. (mA)	
				L ↓ 30%	T ↑ 40°C
HPIT3010-1R0N-LF	1.00	30	84.5	1300	1400
HPIT3010-1R5N-LF	1.50	30	104	1200	1300
HPIT3010-2R2M-LF	2.20	20	124	1100	1100
HPIT3010-3R3M-LF	3.30	20	182	870	940
HPIT3010-4R7M-LF	4.70	20	247	750	780
HPIT3010-6R8M-LF	6.80	20	390	610	630
HPIT3010-100M-LF	10.0	20	585	500	510
HPIT3010-150M-LF	15.0	20	962	400	400
HPIT3010-220M-LF	22.0	20	1339	350	350
HPIT3010-330M-LF	33.0	20	2015	260	275
HPIT3010-470M-LF	47.0	20	2665	220	235

#### HPIT3015 Series

Part Number	L (uH)	Tolerance (±%)	Rdc Max.(mΩ)	Idc Typ. (mA)	
				L ↓ 30%	T ↑ 40°C
HPIT3015-1R0N-LF	1.00	30	39	2100	2100
HPIT3015-1R5N-LF	1.50	30	52	1800	1820
HPIT3015-2R2M-LF	2.20	20	78	1480	1500
MPIT3015-3R3M-LF	3.30	20	104	1210	1230
HPIT3015-4R7MLF	4.70	20	156	1020	1040
HPIT3015-6R8M-LF	6.80	20	208	870	880
HPIT3015-100M-LF	10.0	20	299	700	710
HPIT3015-150M-LF	15.0	20	468	560	560
HPIT3015-220M-LF	22.0	20	676	470	470
HPIT3015-330M-LF	33.0	20	1092	390	370
HPIT3015-470M-LF	47.0	20	1742	320	300

**SMD Power Inductor(HPIT Series) 贴片功率电感 HPIT 系列**

**Electrical Characteristics 电气性能**

**HPIT4018 Series**

Part Number	L ( $\mu$ H)	Tolerance ( $\pm$ %)	Rdc Max.(m $\Omega$ )	Idc Typ. (mA)	
				L $\downarrow$ 30%	T $\uparrow$ 40 $^{\circ}$ C
HPIT4018-1R0N-LF	1.00	30	39	4000	1830
HPIT4018-2R2M-LF	2.20	20	78	2700	1440
HPIT4018-3R3M-LF	3.30	20	91	2000	1230
HPIT4018-4R7M-LF	4.70	20	117	1700	1200
HPIT4018-6R8M-LF	6.80	20	143	1450	1060
HPIT4018-100M-LF	10.0	20	234	1200	840
HPIT4018-150M-LF	15.0	20	325	940	650
HPIT4018-220M-LF	22.0	20	468	800	590
HPIT4018-330M-LF	33.0	20	689	650	490
HPIT4018-470M-LF	47.0	20	845	570	420
HPIT4018-680M-LF	68.0	20	1300	470	320
HPIT4018-101M-LF	100.0	20	1950	400	270
HPIT4018-151M-LF	150.0	20	3250	310	220
HPIT4018-221M-LF	220.0	20	5200	270	170

**HPIT4026 Series**

Part Number	L ( $\mu$ H)	Tolerance ( $\pm$ %)	Rdc Max.(m $\Omega$ )	Idc Typ. (mA)	
				L $\downarrow$ 30%	T $\uparrow$ 40 $^{\circ}$ C
HPIT4026-1R0N-LF	1.00	30	39	3100	2300
HPIT4026-2R2M-LF	2.20	20	52	2100	1970
HPIT4026-3R3M-LF	3.30	20	65	1800	1700
HPIT4026-4R7M-LF	4.70	20	71.5	1450	1600
HPIT4026-6R8M-LF	6.80	20	84.5	1300	1500
HPIT4026-100M-LF	10.0	20	110.5	1000	1300
HPIT4026-220M-LF	22.0	20	143	900	1100
HPIT4026-220M-LF	33.0	20	214.5	610	900
HPIT4026-470M-LF	47.0	20	260	540	800
HPIT4026-101M-LF	100.0	20	390	410	650

**SMD Power Inductor(HPIT Series) 贴片功率电感 HPIT 系列**

**Electrical Characteristics 电气性能**

**HPIT6045 Series**

Part Number	L (uH)	Tolerance (±%)	Rdc Max.(mΩ)	Idc Typ. (mA)	
				L ↓ 30%	T ↑ 40°C
HPIT6045-1R0N-LF	1.00	30	19	8500	4200
HPIT6045-1R3NLF	1.30	30	21	8000	4000
HPIT6045-1R8N-LF	1.80	30	24	7000	3700
HPIT6045-2R3N-LF	2.30	30	27	6000	3500
HPIT6045-3R0N-LF	3.00	30	31	5000	3200
HPIT6045-4R5M-LF	4.50	20	41	4000	3000
HPIT6045-6R3M-LF	6.30	20	50	3800	2800
HPIT6045-100M-LF	10.0	20	62	3000	2500
HPIT6045-150M-LF	15.0	20	100	2300	1900
HPIT6045-220M-LF	22.0	20	150	1900	1500
HPIT6045-330M-LF	33.0	20	189	1500	1400
HPIT6045-470M-LF	47.0	20	286	1300	1100
HPIT6045-680M-LF	68.0	20	429	1000	900
HPIT6045-101M-LF	100.0	20	650	800	700

**HPIT8040 Series**

Part Number	L (uH)	Tolerance (±%)	Rdc Max.(mΩ)	Idc Typ. (mA)	
				L ↓ 30%	T ↑ 40°C
HPIT8040-0R9N-LF	0.90	30	8	11000	7800
HPIT8040-1R4N-LF	1.40	30	10	9000	7000
HPIT8040-2R0N-LF	2.00	30	12	7400	6300
HPIT8040-3R6N-LF	3.60	30	20	5300	4900
HPIT8040-4R7N-LF	4.70	30	24	4700	4100
HPIT8040-6R8N-LF	6.80	30	33	4000	3700
HPIT8040-100M-LF	10.0	20	45	3400	3100
HPIT8040-150M-LF	15.0	20	65	2700	2400
HPIT8040-220M-LF	22.0	20	86	2200	2200
HPIT8040-330M-LF	33.0	20	130	1900	1700
HPIT8040-470M-LF	47.0	20	195	1500	1400
HPIT8040-680M-LF	68.0	20	299	1200	1100
HPIT8040-101M-LF	100.0	20	377	1000	1000

1. L , Idc: Agilent/HP 4284A , 100KHz with 0.1V.
3. Rdc : DIGITAL MILLIOHM METER Chroma 16502, or equivalent.
4. IDC1: Based on inductance change ( $\Delta L/L_0$ :  $\leq -30\%$ ) @ ambient temp. 25°C  
IDC2: Based on temperature rise ( $\Delta T$ : 40°C TYP.)
5. Operating temperature range from -25°C to 85°C.