

SMD Power Inductor(HLSL Series) 贴片功率电感 HLSL 系列

FEATURES 特点

- **High heat resistance and excellent solderability.**
良好的可焊性
- **Excellent terminal strength construction.**
良好的焊盘结构
- **Magnetically shielded construction. 磁屏蔽结构**
- **Surface mount inductor with high current rating.**
大电流表面贴装电感



APPLICATIONS 应用

- **Ideally used in Digital camera, notebook PC, LCD/LED TV set, DC-DC Converters, etc.**
用于数码相机、笔记本电脑、LCD/LED 电视、DC-DC 转换等。

Product Identification 产品标识

HLSL 0755 - 100 M : LF
 ① ② ③ ④ ⑤

- ① **Series name 系列名称**
- ② **Product dimensions 产品尺寸**
- ③ **Inductance Value 电感量: (100: 10uH; 101:100uH)**
- ④ **Inductance Tolerance 电感量公差: (M:20% N:30%)**
- ⑤ **Lead free products 无铅产品**

Shapes And Dimensions 外形及尺寸示意图

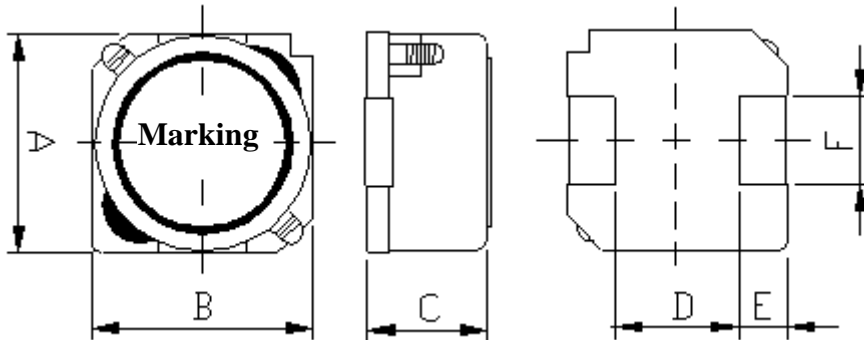

Series	Dimensions(mm)					
	A	B	C Max.	D typ.	E Ref.	F
HLSL0628	6.0±0.3	6.0±0.3	3.0	4.0	0.9	2.0±0.1
HLSL0645	6.0±0.3	6.0±0.3	4.8	4.0	0.9	2.0±0.1
HLSL0745	7.0±0.3	7.0±0.3	4.8	4.9	0.9	2.0±0.1
HLSL0755	7.0±0.3	7.0±0.3	5.8	4.9	0.9	2.0±0.1
HLSL10145	10.1±0.3	10.1±0.3	4.8	6.0	2.0	3.0±0.1
HLSL12555	12.5±0.3	12.5±0.3	5.8	8.5	2.0	3.0±0.1

Electrical Characteristics 电气性能

HLSL0628 Series

Part Number	L (μ H)	Tolerance	Test freq. (KHz)	DCR max. ($m\Omega$)	Isat Max. (A)
HLSL0628-4R7 □-LF	4.70	$\pm 20\%, 30\%$	100	35	1.60
HLSL0628-6R8 □-LF	6.80	$\pm 20\%, 30\%$	100	43	1.50
HLSL0628-100 □-LF	10.0	$\pm 20\%, 30\%$	100	64	1.30
HLSL0628-150 □-LF	15.0	$\pm 20\%, 30\%$	100	90	1.00
HLSL0628-220 □-LF	22.0	$\pm 20\%, 30\%$	100	125	0.70
HLSL0628-330 □-LF	33.0	$\pm 20\%, 30\%$	100	178	0.69
HLSL0628-470 □-LF	47.0	$\pm 20\%, 30\%$	100	252	0.59
HLSL0628-680 □-LF	68.0	$\pm 20\%, 30\%$	100	348	0.50
HLSL0628-101 □-LF	100	$\pm 20\%, 30\%$	100	516	0.42

HLSL0645 Series

HLSL0645-1R0 □-LF	1.00	$\pm 20\%, 30\%$	100	23	2.70
HLSL0645-1R5 □-LF	1.50	$\pm 20\%, 30\%$	100	26	2.30
HLSL0645-2R2 □-LF	2.20	$\pm 20\%, 30\%$	100	28	1.90
HLSL0645-3R3 □-LF	3.30	$\pm 20\%, 30\%$	100	35	1.80
HLSL0645-4R7 □-LF	4.70	$\pm 20\%, 30\%$	100	40	1.40
HLSL0645-6R8 □-LF	6.80	$\pm 20\%, 30\%$	100	45	1.20
HLSL0645-100 □-LF	10.0	$\pm 20\%, 30\%$	100	60	1.00
HLSL0645-120 □-LF	12.0	$\pm 20\%, 30\%$	100	65	0.90
HLSL0645-150 □-LF	15.0	$\pm 20\%, 30\%$	100	70	0.80
HLSL0645-180 □-LF	18.0	$\pm 20\%, 30\%$	100	90	0.70
HLSL0645-220 □-LF	22.0	$\pm 20\%, 30\%$	100	110	0.65
HLSL0645-270 □-LF	27.0	$\pm 20\%, 30\%$	100	138	0.60
HLSL0645-330 □-LF	33.0	$\pm 20\%, 30\%$	100	165	0.55
HLSL0645-390 □-LF	39.0	$\pm 20\%, 30\%$	100	195	0.50
HLSL0645-470 □-LF	47.0	$\pm 20\%, 30\%$	100	220	0.45
HLSL0645-560 □-LF	56.0	$\pm 20\%, 30\%$	100	255	0.40
HLSL0645-680 □-LF	68.0	$\pm 20\%, 30\%$	100	285	0.37
HLSL0645-820 □-LF	82.0	$\pm 20\%, 30\%$	100	365	0.33
HLSL0645-101 □-LF	100	$\pm 20\%, 30\%$	100	420	0.30

Electrical Characteristics 电气性能

HLSL0745 Series

Part Number	L (μ H)	Tolerance	Test freq. (KHz)	DCR max. (m Ω)	Rated Current (A)
HLSL0745-3R3 □-LF	3.30	$\pm 20\%, 30\%$	100	24	2.50
HLSL0745-4R7 □-LF	4.70	$\pm 20\%, 30\%$	100	36	2.00
HLSL0745-6R8 □-LF	6.80	$\pm 20\%, 30\%$	100	47	1.70
HLSL0745-100 □-LF	10.0	$\pm 20\%, 30\%$	100	55	1.30
HLSL0745-150 □-LF	15.0	$\pm 20\%, 30\%$	100	62	1.10
HLSL0745-220 □-LF	22.0	$\pm 20\%, 30\%$	100	73	0.90
HLSL0745-330 □-LF	33.0	$\pm 20\%, 30\%$	100	115	0.82
HLSL0745-470 □-LF	47.0	$\pm 20\%, 30\%$	100	150	0.75
HLSL0745-680 □-LF	68.0	$\pm 20\%, 30\%$	100	210	0.60
HLSL0745-101 □-LF	100	$\pm 20\%, 30\%$	100	300	0.50
HLSL0745-151 □-LF	150	$\pm 20\%, 30\%$	100	408	0.40
HLSL0745-221 □-LF	220	$\pm 20\%, 30\%$	100	624	0.33
HLSL0745-331 □-LF	330	$\pm 20\%, 30\%$	100	888	0.25
HLSL0745-471 □-LF	470	$\pm 20\%, 30\%$	100	1260	0.22
HLSL0745-681 □-LF	680	$\pm 20\%, 30\%$	100	1776	0.20
HLSL0745-102 □-LF	1000	$\pm 20\%, 30\%$	100	2736	0.14

HLSL0755 Series

HLSL0755-1R0 □-LF	1.00	$\pm 20\%, 30\%$	100	19	7.00
HLSL0755-1R8 □-LF	1.80	$\pm 20\%, 30\%$	100	23	6.00
HLSL0755-2R2 □-LF	2.20	$\pm 20\%, 30\%$	100	29	4.80
HLSL0755-4R7 □-LF	4.70	$\pm 20\%, 30\%$	100	37	3.30
HLSL0755-100 □-LF	10.0	$\pm 20\%, 30\%$	100	47	2.50
HLSL0755-150 □-LF	15.0	$\pm 20\%, 30\%$	100	61	2.20
HLSL0755-220 □-LF	22.0	$\pm 20\%, 30\%$	100	72	1.70
HLSL0755-330 □-LF	33.0	$\pm 20\%, 30\%$	100	105	1.40
HLSL0755-470 □-LF	47.0	$\pm 20\%, 30\%$	100	156	1.20
HLSL0755-680 □-LF	68.0	$\pm 20\%, 30\%$	100	240	1.00
HLSL0755-101 □-LF	100	$\pm 20\%, 30\%$	100	352	0.70
HLSL0755-221 □-LF	220	$\pm 20\%, 30\%$	100	660	0.55

Electrical Characteristics 电气性能

HLSL10145 Series

Part Number	L (uH)	Tolerance	Test freq. (KHz)	DCR max. (m Ω)	Rated Current (A)
HLSL10145-3R3 □-LF	3.30	±20%,30%	1	20	4.90
HLSL10145-5R6 □-LF	5.60	±20%,30%	1	27	3.80
HLSL10145-100 □-LF	10.0	±20%,30%	1	44	3.00
HLSL10145-150 □-LF	15.0	±20%,30%	1	57	2.40
HLSL10145-220 □-LF	22.0	±20%,30%	1	71	2.10
HLSL10145-330 □-LF	33.0	±20%,30%	1	98	1.60
HLSL10145-470 □-LF	47.0	±20%,30%	1	121	1.40
HLSL10145-680 □-LF	68.0	±20%,30%	1	168	1.20
HLSL10145-101 □-LF	100	±20%,30%	1	240	1.00
HLSL10145-151 □-LF	150	±20%,30%	1	420	0.79
HLSL10145-221 □-LF	220	±20%,30%	1	564	0.65
HLSL10145-331 □-LF	330	±20%,30%	1	816	0.54
HLSL10145-471 □-LF	470	±20%,30%	1	1236	0.47
HLSL10145-681 □-LF	680	±20%,30%	1	1920	0.38
HLSL10145-102 □-LF	1000	±20%,30%	1	3360	0.32

HLSL12555 Series

Part Number	L (uH)	Tolerance	Test freq. (KHz)	DCR max. (m Ω)	Rated Current (A)
HLSL12555-3R3 □-LF	3.30	±20%,30%	1	16	4.00
HLSL12555-5R6 □-LF	5.60	±20%,30%	1	20	3.60
HLSL12555-100 □-LF	10.0	±20%,30%	1	26	3.40
HLSL12555-150 □-LF	15.0	±20%,30%	1	32	2.80
HLSL12555-220 □-LF	22.0	±20%,30%	1	41	2.30
HLSL12555-330 □-LF	33.0	±20%,30%	1	50	1.90
HLSL12555-470 □-LF	47.0	±20%,30%	1	75	1.60
HLSL12555-680 □-LF	68.0	±20%,30%	1	100	1.30
HLSL12555-101 □-LF	100	±20%,30%	1	140	1.10
HLSL12555-151 □-LF	150	±20%,30%	1	228	0.88
HLSL12555-221 □-LF	220	±20%,30%	1	324	0.72
HLSL12555-331 □-LF	330	±20%,30%	1	492	0.59
HLSL12555-471 □-LF	470	±20%,30%	1	624	0.49
HLSL12555-681 □-LF	680	±20%,30%	1	912	0.43
HLSL12555-102 □-LF	1000	±20%,30%	1	1344	0.34

1. Rated Current: it is either the inductance is 30% lower than its nominal value in D.C. saturation characteristics or temperature rise becomes $\Delta T=40^{\circ}\text{C}$, whichever is lower.